

# SOLID METAL

## TROUBLESHOOTING

Scuffmaster

### INTRODUCTION

**OVERVIEW:** It can be helpful to know what not to do when applying a patterned finish for the first time.

## READ PRIOR TO BEGINNING APPLICATION

### WRONG COLOR – STRIPING

# 1

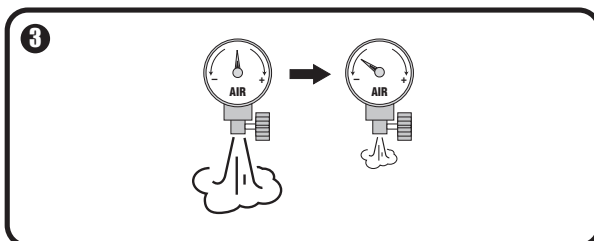
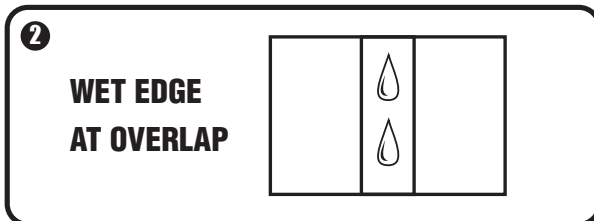
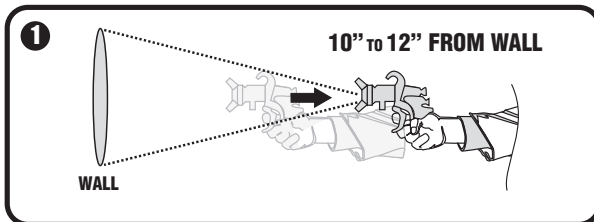

### STRIPING: ( SMOOTH ) VERTICAL OR HORIZONTAL BANDING

**CAUSE 1:** MC2000 sprayed with the gun too close to the surface.

**CAUSE 2:** Sprayed with a wet edge.

**CAUSE 3:** Air pressure was too high, narrowing the spray fan.

**SOLUTION:** Once dry spray is detected stop spraying. Let finish dry and lightly sand smooth with fine grit sand paper.

**NOTE:** If textured becomes too coarse, the entire surface must be sanded smooth with a fine-grit sandpaper. When surface is smooth, apply a light pass of the MC2000.

**WARNING:** Do not try to bury the texture with a heavy pass of MC2000.

## DRYSPRAY

# 2

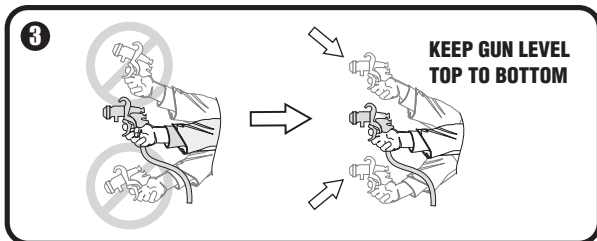
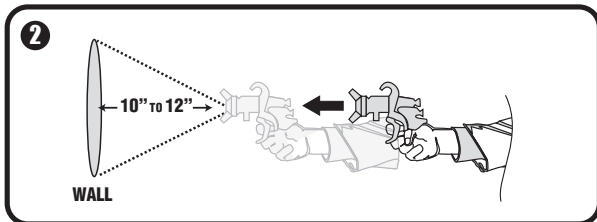
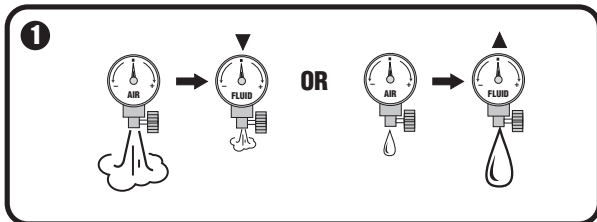

### DRY SPRAY: ( TEXTURE/GRITTY ) CONSISTENT GRITTY TEXTURE – MOST COMMON NEAT THE CEILING AND FLOOR

**CAUSE 1:** MC2000 applied using wrong pressure settings: too much air pressure or not enough fluid pressure.

**CAUSE 2:** Gun was too far from the wall causing paint to partially dry in mid-air.

**CAUSE 3:** Bad spray technique. The gun was arched at the top and bottom of the spray stroke

**SOLUTION:** Once dry spray is detected stop spraying. Let finish dry and lightly sand smooth with fine grit sand paper.

**NOTE:** If textured becomes too coarse, the entire surface must be sanded smooth with a fine-grit sandpaper. When surface is smooth, apply a light pass of the MC2000.

**WARNING:** Do not try to bury the texture with a heavy pass of MC2000.

## BLOTCHING

# 3

### BLOTCHING: ( SMOOTH ) IRREGULAR PATCHES OF DISCOLORATION

**CAUSE 1:** Too much material applied at one time.

**CAUSE 2:** RUSHING – Did not allow sufficient dry time between coats

**SOLUTION:** Wait until previous finish is completely dry. Apply a very light pass of the MC2000.

**NOTE:** Normally, one pass is enough, but two or three may be necessary.

## WRONG COLOR

4



### WRONG COLOR ( SMOOTH )

**CAUSE :** Insufficient paint preparation. Be sure that all sediment is mixed off the bottom of the can

**SOLUTION:** If it was an otherwise good installation, simply obtain the right color material and apply 2-3 light passes right over the protective clear coat.

## SAGGING

5

### SAGGING ( TEXTURE )

**CAUSE 1 :** Too much material applied at once.

**CAUSE 1 :** Material was over-thinned

**SOLUTION:** Let MC2000 dry. Sand sagging area until smooth. Then, apply 1-2 light passes of MC2000.

**WARNING: DO NOT SAND THROUGH TO PRIMER!**

## FLASHING

6

### FLASHING ( SMOOTH )

**CAUSE 1 :** Insufficient clear coat application.

**SOLUTION:** Apply another coat of clear coat.

**NOTE TO CONTRACTOR:** If you have questions or issues, please do not hesitate to contact our Technical Services team at 800.898.0219 ext. 4859

technical support: 1.800.898.0219

documents: [www.scuffmaster.com](http://www.scuffmaster.com)



MC2000 – TROUBLESHOOTING



Pretty. Tough. Paint.™