

SMOOTH PEARL

TROUBLESHOOTING



INTRODUCTION

OVERVIEW: It can be helpful to know what not to do when applying a patterned finish for the first time.

READ PRIOR TO BEGINNING APPLICATION

WRONG COLOR – TO DARK

1

TOO DARK WHEN COMPARED TO CONTROL SAMPLE

CAUSE : Not enough Clear Pearl Coat (CPC)

SOLUTION: The CPC, because it is a mica flake, will lighten the base color. Apply another light mist coat over the finish.

NOTE: Make sure to check the color of the finish before the application of the Ultra Clear protective clear coat. If the color does not match it will be easier (and cheaper) to fix the issue if the protective clear coat was not applied.

WRONG COLOR – TO LIGHT

2

TOO LIGHT WHEN COMPARED TO CONTROL SAMPLE

CAUSE : Too much Clear Pearl Coat (CPC)

SOLUTION: Typically, correcting this issue requires reapplying the base coat and spraying the CPC with lighter mist coats.

NOTE: MC100 can be applied directly over the CPC. This does not require re-priming.

SUEDE OR CLOUDY APPEARANCE

3

SUEDE OR CLOUDY APPEARANCE

CAUSE : A mist coat of the Clear Pearl Coat (CPC) was applied with the gun too far from the wall.

SOLUTION: Attempt to apply another light pass.

NOTE: If the contractor is not able to fix the problem by another light pass of the CPC it will be necessary for the contractor to start over using the correct spray technique.

STRIPING

4

STRIPING

CAUSE : CPC was sprayed using a wet-edge, building too heavy of a coat.

SOLUTION: Re-apply the MC100 base coat, one or two mist coats of CPC and finally the UC Satin/Flat/Gloss

NOTE: The CPC must be sprayed as a light, mist coat. Do not spray a full, wet coat.

DRY SPRAY

5

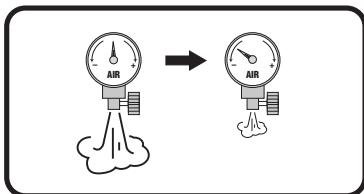

DRY SPRAY

CAUSE : CPC was applied using too much air pressure

SOLUTION: Wait until the CPC dries and lightly sand the finish smooth and reapply a light coat of the CPC to mask any burnishing from sanding.

NOTE: Depending on the severity of the dry spray, it may be required to start over with the color coat.

technical support: 1.800.898.0219

documents: www.scuffmaster.com



CLEAR PEARL COAT – TROUBLESHOOTING

